



JESSICA HOWARD

CREATIVE DIRECTOR /
MARKETING MANAGER



jessica@10oclockmedia.com



443.880.5334



jessicahowardportfolio.com



Fort Lauderdale, FL 33312



WORK EXPERIENCE

MARKETING
COORDINATOR
2016-2019

PIRTLE CONSTRUCTION

*Marketing and Promotional Designs
Website Design and Content management
Social Media Management
Design and implement proposals and presentations
Design and print all business materials (brochures,
flyers, ads, business cards and trade show displays)*

CREATIVE
DIRECTOR /
OFFICE
MANAGER
2014-2016

CJS GLOBAL, LLC

*Helped Expand a \$1 Million Business to a \$10 Million
and 3 territories in less than 2 years
Office Management for 3 territories (South Florida,
Central Florida and Texas)
Website Design, Development and Content
Management (including social media)
Digital Asset and Content Management
Creative Director for all Janitorial Proposals and
Company-Wide Print Media
Creation and Implementation of Administrative and
Field Management Procedures
Create Invoices, Input Payments and Help Process
Payroll through QuickBooks Premier 2016*

GRAPHIC
DESIGNER /
DATABASE
SPECIALIST
2012-2014

ELITE CREW INTERNATIONAL

*Marketing and Promotional Designs
Crew Photographer / Photo Editor
Website Design and Content Management
(including social media)
Digital Asset and Content Management
Streamlined Digital Business Processes
Advertisement Design and Placement
(Dockwalk and Superyacht Magazine)*

GRAPHIC
DESIGNER
2010-2012

COAST TO COAST PUBLISHING

*Advertisement Design, Website Design
Photo Editing, Logo Designs*

GRAPHIC
DESIGNER
2008-2010

LASER ADVERTISING

*Brochure Designs, Digital Illustrations, Photo Editing
Advertisement Design and Placement
(Yachting Magazine, Dockwalk, Powerboating, etc..)*



EDUCATION

2007-2008

THE ART INSTITUTE OF FORT LAUDERDALE
Associate of Science Degree in Graphic Design

2004-2006

SALISBURY UNIVERSITY, SALISBURY, MD
General Studies / Prerequisites



FREELANCE

I worked for various companies, such as Boca Valley Realty, Landy Marketing, Sharp Water and Lighthouse Point Magazine to create Brochures, Advertisements, Marketing and Promotional Designs, Home Show Booth Designs, Vehicle Graphics, Advertisements, Logo and Website designs.



PROFESSIONAL SKILLS

- Graphic Design
- Web Design
- Social Media
- Google Apps
- Adobe Photoshop
- Adobe InDesign
- Adobe Illustrator
- Adobe Acrobat
- HTML & CSS
- MS Office
- Quickbooks



PERSONAL SKILLS

- Creative
- Teamwork
- Innovate
- Organization
- Communication
- IT Work

Jessica Howard *designs*

443.880.5334 | jessica@10oclockmedia.com

ADVERTISEMENTS

by Jessica Howard

PIRTLE CONSTRUCTION

COMMITTED TO EXCELLENCE
FROM CONCEPT TO COMPLETION



AREAS OF CONSTRUCTION

-  ATHLETIC & SPORTS COMPLEXES
-  CULTURAL / PERFORMING ARTS
-  EDUCATION: K-12, HIGHER & PRIVATE
-  GOVERNMENT / MUNICIPAL
-  HOSPITALITY & DINING
-  INTERIOR BUILD-OUTS
-  LEED / SUSTAINABILITY / BIM
-  OFFICE & PARKING GARAGES
-  PUBLIC SAFETY
-  RESEARCH & HEALTHCARE
-  RETAIL / PRIVATE DEVELOPMENT

FLORIDA'S PREMIER BUILDER

Since 1968 Pirtle Construction has been focused on providing excellence in every phase of construction. Building is our passion. Everything we do is centered around providing our staff and clients with the best experience possible.

Pirtle Construction is not just a construction company but a family, a partner, and an ally to all that work for and with us. Our employees are, and have always been, an integral part of Pirtle's success and are the key that make us one of the most respected builders in Florida.

Join our winning team!



www.pirtleconstruction.com

Offices in Orlando, West Palm Beach,
Fort Lauderdale & Miami

CGC 055033

Your Dream
is our next project



Dreaming of a more beautiful space? Let us help you turn your home improvement project into reality!

We specialize in creating amazing *kitchens* and *bathrooms*. And, we do everything from hardwood flooring, room additions to complete home remodels.

We offer everything from planning, 3D visual design to full service construction.

"You Dream It ~ We Build It"

FREE In-Home Estimates

Mention the "Country Club Special" and receive \$800 OFF* (*Project of \$10,000 or more)

949-498-9901
KrecuConstruction.com

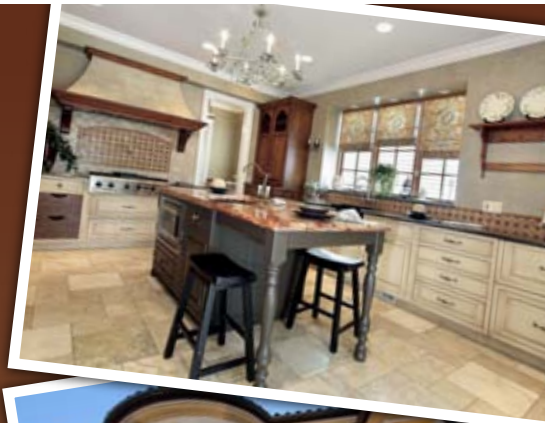



Abbey Carpet & Floor®

America's choice in floor fashions since 1958.

858-566-2950

760.744.4898

sandiego.abbeycarpet.com

9446 Miramar Road

San Diego, CA 92126



Carpet • Hardwood • Laminate
Tile • Area Rugs • Marmoleum
Eco Friendly Floors • Exotics
Natural Stone • Bamboo



Learning is about you, your project, what it is that you are trying to accomplish. It is also about continually educating ourselves so as to always be offering the best products and services.

Inspiring is about sharing ideas and knowledge that will help you achieve more than you are even hoping to get out of your project.

Creating is about designing sought after living spaces as well as providing an unparalleled experience.



Learning. Inspiring. Creating.

Our Team Approach brings systematic procedures to ensure client experiences at the cabinetry design studio are unmatched. A focused, knowledgeable staff, with pronounced individual strengths, blend together seamlessly. When you hire the cabinetry design studio you get a team of people that will work closely with you to bring your project to life right before your eyes.

856.354.9090 | www.cabinettree.com



THE YACHT TENDER EXPERTS

SERVING THE YACHTING INDUSTRY FOR OVER 35 YEARS





BUY – SELL – TRADE – BROKER • WORLD-WIDE SALES AND SHIPPING

Novurania • Jupiter • Avon • Midnight Express • Nautica • Sea/Vee • Zodiac • Intrepid • Contender

Skip Reisert • 954-854-9156 • Skip@tendercareboats.com • www.tendercareboats.com

Specializing in Custom Therapeutic Body Work

My vision was to create a space that could help relieve myofascial pain, stress and discomfort by melding Western Medical Massage with Eastern modalities and philosophies. It is now almost 10 years later with the support of my clients and family; U-Knead-A Massage Inc. has become just that. UKAM has some of the best massage therapist in Port Charlotte with one commonality, a passion for helping people. Therapies are available by appointment Monday-Saturday.

I would like to thank everyone who helped this dream come true.

Yours in good health,

Minerva Noltee LMT, CNMT, CTMP (owner)

U-Knead-A Massage

941-234-6759
750 Tamiami Trail #2
Port Charlotte, FL 33953

Royal Thai/Yoga Massage
Neuromuscular Therapy
Soothing Hot Stone Massage
Prenatal Massage
Thai Foot Treatments

\$5 Off
First Visit
with this ad

Money saving packages
Gift Certificates
Licensed, Qualified,
Intuitive Body Workers

"Each session is much more than just massage, it's an experience."

- U-Knead-A-Massage client

Lic # MA39051/MM18709



French's Construction

French's Construction is a family owned business providing residential and commercial services to Ft Bend, Southwest Houston, and surrounding areas. Love your Neighborhood (but not your kitchen, or bath)? No problem. French's can help you realize your dream home, without changing your address.

We are a full service design and build contractor. You and your family are seeking solutions and we have the expertise and experience to solve them. All estimates are prompt, detailed and in contract form. We exceed our competitor's quality and pricing on a regular basis, thereby insuring long term relationships with all of our customers.

281-830-0037
frenchsconstruction.com

**EXPERIENCE. PROFESSIONALISM.
SERVICING YOUR NATIONWIDE AUTO SHIPPING NEEDS.**



Envision Auto is the premier auto transport company in South Florida. Our staff actively guides and informs clients such as private individuals and auto dealers on the most economically efficient way to transport any number of vehicles within the Continental United States, Hawaii, Alaska, and the Caribbean. At Envision Auto we build strong relationships with our customers because they consistently see the value we provide with our hard working team. Much of the strength of Envision Auto is through our people; great service and technology and the fact that we're always adding true value to our customers. With access to over 3,000 carriers, we have the ability to transport your vehicle by open or enclosed carrier at anytime, to any location. We are fully licensed and insured as required by the Federal Motor Carrier Safety Administration (FMCSA). Our Motor Carrier license number is 727407.

Here at Envision Auto Relocations you will receive:

- Upfront, honest answers • A personal shipping guide • 5 Star Rated shipping services
- Door to door transportation • Full Insurance Coverage up to \$1 Million
- Accurate Open & Enclosed vehicle shipping quotes • The most accurate & competitive pricing
- The experience required to assist you in moving your vehicle, when you need it



(888) 847-6923 or (561) 210-7790

www.EnvisionRelocations.com

**2290 NW 2nd Ave Suite 7
Boca Raton, FL 33431**

Prout

INTERNATIONAL

BUILDING THE FINEST LUXURY YACHTS ON THE PLANET



As Prout International's team of artisans and engineers, known for their exceptionally high quality sailing yachts, following the tradition of the firm since 1955. This 4-stateroom 85' cruising Maxi sailing yacht is available by default. Her hull, deck, bulkheads and machinery are complete, allowing for timely delivery. Fitted with only the finest gear and ancillary equipment making China Doll a superior all ocean passage maker. Offered at \$4,000,000!

Michael Ferris • Tel: 561-662-1001 • Email: mferris@proutinternational.com



Hull #11 originally custom built for a knowledgeable world-class sailor. The current owner added many important upgrades to prepare for and complete a 3.5 year, 60,000nm circumnavigation! The current owner is moving up to a new, larger Prout catamaran. This trade-in is priced below market value and must be sold. Offered at \$649,000. Lying Thailand. Call for complete photo essay and details.

Gary Fretz • Tel: 954-609-6282 • Email: gfretz@proutinternational.com



YEAR: 2008

LOA: 85 ft. – 27.97 m

LWL: 69 ft. – 21.3 m

BEAM: 22.2 ft – 6.77 m

DRAFT: 9 ft. – 2.75 m

FUEL: 750 USG – 3,000 L

WATER: 750 USG – 3,000 L



YEAR: 2002

LOA: 57 ft. – 17.4 m

LWL: 52 ft. – 15.8 m

BEAM: 30 ft – 9.14 m

DRAFT: 4.6 ft. – 1.4 m

FUEL: 198 USG – 749.5 L

WATER: 264 USG – 999.3 L



WWW.PROUTINTERNATIONAL.COM

Chef Jay

On Your Way Chef Jay, Inc.

I shop, chop, and cook!

Dinner Parties / Catering / Private Lessons / Dinner for two

Romantic dinners made easy. A special occasion or no occasion at all, nothing is too small if you have an appetite. Bar-b-cue's, bachelor(ette) parties, business lunch and dinner. Simply put, maybe you just want to impress your guests with a chef in your home?



Phone: 702-806-1447

Web Address: onyourwaychefjay.com

E-mail: Jay@onyourwaychefjay.com

COLLATERAL MATERIALS

PIRTLE CONSTRUCTION

by Jessica Howard

CHRISTMAS CARD



WINE LABEL



TRADESHOW BANNERS

PIRTLE

LEADERS IN SUSTAINABILITY

- Founders Circle Member - USGBC Florida
- Headquarters is a LEED Silver Building
- "Most Outstanding Green Business" by the USGBC

34
LEED
PROJECTS
IN FLORIDA



PLATINUM



Galaxy Elementary School



GOLD



Miramar Police Headquarters



GOLD



FAU / Pine Jog Environmental Education Center

FLORIDA'S PREMIER BUILDER

www.pirtleconstruction.com

PIRTLE

BUILDING INFORMATION MODELING

- 3D, 4D, 5D and 6D BIM Capabilities
- All of Our Projects Use BIM
- In-house BIM Specialists



Broward County Judicial Center



St. Brendan High School



Young at Art Museum

FLORIDA'S PREMIER BUILDER

www.pirtleconstruction.com

50TH ANNIVERSARY BANNER



1968

DID YOU KNOW?

**Pirtle Construction was
Incorporated on April 15th**

The average cost of a new
house was \$14,950

The Apollo 7 mission
made the first live TV
broadcast from space

Minimum wage was \$1.60

Boeing rolled out the 747
Jumbo Jet

The Intel processor was
invented

Emergency 911 Telephone
service started in the US

CBS-TV's "60 Minutes"
debuted

The first successful heart
transplant was performed

pirtleconstruction.com

BROCHURE

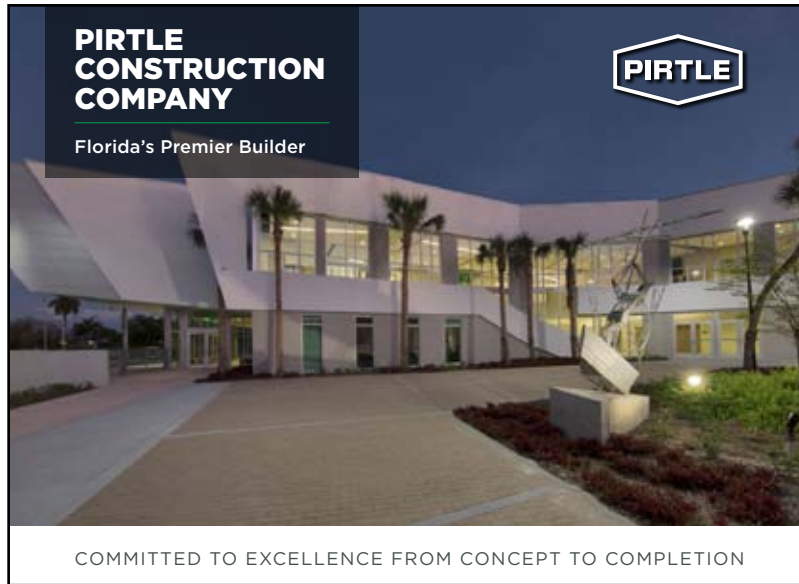

HISTORY

Since 1968 Pirtle Construction Company (Pirtle) has been committed to delivering excellence from concept to completion. Pirtle has earned a solid reputation providing exceptional client service and completing high quality projects within budget, and ahead of schedule.



INNOVATION

Building Information Modeling (BIM)

Pirtle's BIM approach is proven to provide our clients more predictability, more productivity, accelerated project schedules, higher quality construction and increased efficiencies in the facility management after completion.





**SERVING ALL OF
FLORIDA**



ZERO LITIGATION

Since our inception in 1968, Pirtle Construction Company has had zero litigation, major disputes or contract defaults with an Owner or Architect on any of our projects.



FINANCIALLY STRONG

Pirtle maintains a strong financial statement. Pirtle has an AM Best Rating of A+ Superior, Financial Rating of Class XIII, an Aggregate Bonding Capacity of \$500,000,000 and a Single Project Capacity of \$150,000,000.



Financial Strength



Composite Credit Appraisal



3D 4D 5D 6D

IN-HOUSE BIM CAPABILITIES

SUSTAINABLE CONSTRUCTION

Our commitment to sustainability starts in house. As a corporate standard we have implemented energy and water saving policies and we provide sustainability training to all of our employees. Pirtle Construction was named the Most Outstanding Green Business by the U.S. Green Building Council.



**34
LEED
PROJECTS**

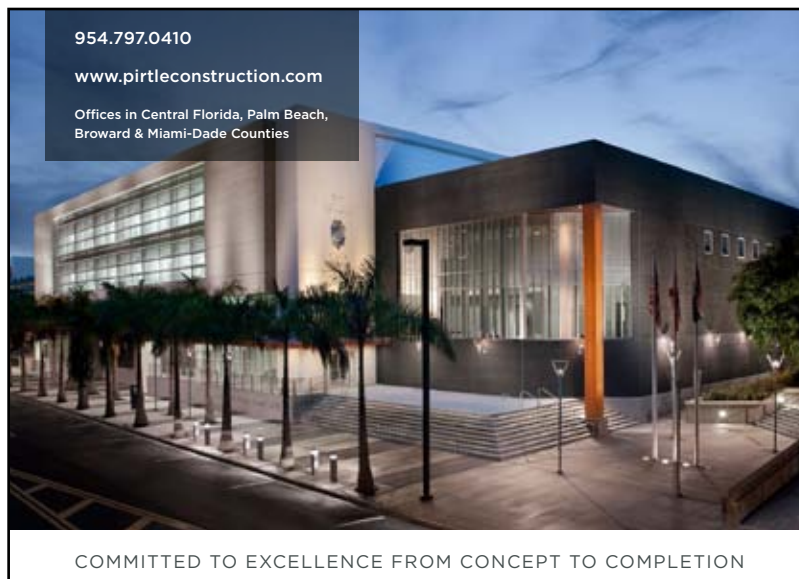

CORPORATE IDENTITY

ELITE CREW INTERNATIONAL

by Jessica Howard

Elite

Crew International Inc.



KARINA BOHOLTE BEFELD
Founder & Senior Crew Agent

ANGELA E. WILSON
Senior Crew Agent / Office Manager

MADELINE BENSCH
Crew Agent

ANNIE HILERIO
Crew Coordinator



Elite
Crew International Inc.

14401 International Lane
www.elitecrewintl.com
714 South East 17th Street
Ft. Lauderdale, FL 33316
Tel: 954.522.0840
Fax: 954.522.9430

Elite

Crew International Inc.



PROVIDING
Dedicated & Professional
Crew Placement Services
For The ~~Leisure~~ Mega
Yacht Industry





KARINA ROHOLTE BEFELD
Founder & Senior Crew Agent
karina@elitecrewintl.com

ANGELA E. WILSON
Senior Crew Agent & Office Manager
angela@elitecrewintl.com



MADELEINE BEN SCH
Crew Agent
madeleine@elitecrewintl.com

NORA J. LEWARK
Placement Coordinator & Receptionist
nora@elitecrewintl.com



ANNIE HILERIO
Crew Coordinator
info@elitecrewintl.com

JESSICA S. HOWARD
Jr. Accountant & Database Specialist
crew@elitecrewintl.com



ALEXANDRA ARREDONDO
Crew Coordinator
alexandra@elitecrewintl.com

BOB BEFELD
Retired Yacht Captain & Consultant



BILL JACKSON
Senior Accountant

CORY HOWARD
IT Managed Services Provider &
Technical Support
www.dynamicsupport.com



714 South East 17th Street
Fort Lauderdale, FL 33316

Ph: 954.522.4840

Fx: 954.522.4930

placement@elitecrewintl.com

www.elitecrewintl.com



PROVIDING
Dedicated & Professional
Crew Placement Services
For The Luxury Mega
Yacht Industry

A REPUTATION that is unsurpassed



CARIBBEAN

PACIFIC



About Elite Crew International
provides professional & dedicated crew placement services to the Mega Yacht community. With our head office strategically located in Fort Lauderdale, Florida "the yachting capital of the World" and skilled recruitment agents worldwide, we are able to have an international presence in this global industry. So whether you need crew in Europe, North America, or anywhere else in the world, we are here for you!

Since early 1998 we have continued to bring a superior, original and hands-on approach to the yachting scene which is still unsurpassed. We have a very loyal following of Owners, Captains and Crew which continues to grow! We currently cater to more than 1800 Mega Yachts, many of which are New Builds, and have over 28,000 registered Crew Members. In addition to world-wide crew placement we can also provide professional Estate Staff. As of 2012, Elite Crew International became yachting's first Private Crew Placement & Recruiting agency to become MLC 2006 Certified!

Quality. Experience. Service.



Owner & Captain Services

- We are MLC 2006 Certified! You can ensure that our service is certified and regulated in accordance with MLC 2006.
- Regardless of the location of your yacht or estate we have crew & staff worldwide.
- You can be assured that each Crew Member has completed a thorough screening and interview process with an experienced Crew Agent.
- Full Reference Checks are completed before candidates are presented.
- Each candidate is hand-selected to meet your specific needs.
- We're here to assist with interview arrangements & offer our Conference Room as a convenient location.
- We can help guide you in such areas as; Crew Salary Guidelines and Crew Contracts.
- We have an extensive database of experienced yachting & estate professionals just waiting for you, whether you are an Owner needing a Captain or a Captain looking for a full crew!



FLORIDA



BAHAMAS

THE WORLD'S FIRST YACHT RECRUITMENT AGENCY TO BE MLC 2006 CERTIFIED



EUROPE



ALASKA

Crew Services

Whether you're seeking employment on a Mega Yacht or in an Estate; we can help.

- We are MLC 2006 Certified and therefore help to Protect your rights as a seafarer.
- Career counseling by an experienced Crew Agent unique to each registered candidate.
- Knowledgeable MCA & USCG licensing specialists available to help you meet today's industry requirements.
- Resume advice and interview techniques to help you get the job.
- A friendly, committed and professional Crew Placement team!
- Never a registration fee!

A LEADER
in the field,
not just riding the wave

MAGAZINE DESIGN

by Jessica Howard

RIVERLAND

& SURROUNDING COMMUNITIES **MAGAZINE**

MAY 2015

PETS & ADOPTION

LEARN WHY IT IS BETTER TO ADOPT, NOT SHOP

HOME IMPROVEMENT

HOW TO CHOOSE YOUR GENERAL CONTRACTOR

COMMUNITY EVENTS

GET OUT AND HAVE FUN WITH THE FAMILY!

Now Presenting The....

PISCO SOUR

{Move Over Whiskey And Amaretto}

This home-grown, handcrafted spirit has been in South America for more than 300 years, and now has exploded throughout the South Florida cocktail scene. After hours of research and tastings, I have my Imbibe pisco decoder ring and can pass some knowledge to our readers.

Pisco is a clear, grape-based distilled spirit that is similar to brandy. It sits between unflavored vodka and botanical gin. Some liken it to grappa, but it is much smoother and softer tasting. Like tequila, piscos come in three variations:

- PURO: single varietal
- ACHOLADO: blend of two or more grape varietals
- MOSTO VERDE: distilled from partially fermented freshpressed grape juice

The origin of the pisco sour is hotly debated, with both Peru and Chili claiming it as their national cocktail. The two kinds of pisco and the two variations in the style of preparing the Pisco Sour are distinct in both production and taste. Try one yourself and tag @mymixologista to share your comments.



PERU VS. CHILI

Peruvian Pisco is authentic fresh grape must* distilled from one or a blend of eight local grape varietals: Italia, Torontel, Moscatel, Albilla, Quebranta, Negra Criolla, Mollar, and Uvina.

- Contained in stainless steel or glass
- Distilled to proof – no water added

- No wood-aging allowed

* very young wine

CHILEAN PISCO IS INFLUENCED

- distilled from three grape varietals: Moscatel, Pedro Jimenez, and Torontel
- Multiple distillations
- May be diluted
- Barrel aging allowed

WHERE TO IMBIBE A PISCO SOUR:

STACHE, 1920's Drinking Den, Downtown Himmarshee District | SWEET NECTAR Charcoal Grille and Spirits, Las Olas Boulevard
THE COCKTAIL COLLECTION at Tobacco Road, Miami | OCEANS 234 in Deerfield Beach features a mango version



PISCO SOUR COCKTAIL RECIPE

By Nick Nistico, Corporate Beverage Program Development Specialist, Premier Beverage Company

- 2 ounces Pisco Portón
- 1 ounce simple syrup
- 1 ounce fresh lemon juice
- 1 egg white

Shake all ingredients without ice first to create a froth.

PRO TIP

an electronic milk frothier works great for this.

Shake with ice and strain into a martini or coupe glass

Garnish with freshly grated cinnamon or a dash of bitters.

TRY THIS

Add 1 ounce of any fruit of your choice to create a flavored Pisco Sour. Mango, Passion Fruit, Strawberry-Basil, Lime-Pomegranate

WEBSITE DESIGN

by Jessica Howard



[COLLECTIONS](#)

[STYLE](#)

[PHOTOGRAPHY](#)

[INSTAGRAM](#)

[PRESS](#)

[STOCK LIST](#)

[CONTACT](#)

[EARRINGS](#)

[RINGS](#)

[NECKLACES](#)

[BRACELETS](#)

[BODY](#)

[ONE OF A KIND](#)



COPYRIGHT 2014 - KAI JEWELS - DESIGN BY 10 O'CLOCK MEDIA

GOTHAM automotive

Welcome

Lorem ipsum dolor sit amet, consectetur adipiscing elit. Quisque vitae quam non nulla dignissim gravida. Curabitur cursus euismod quam, non ornare massa commodo id. Quisque tempus sapien eu dui ultricies in pulvinar odio tincidunt. Donec libero nulla, laoreet vel auctor quis, tristique a dolor. Ut non quam nec quam imperdiet porttitor vitae ac justo. Vivamus porttitor varius turpis, sed faucibus lorem porta ut. Vivamus nulla risus, blandit in pharetra cursus, placerat et nunc.

Aenean quis sagittis justo. Nulla eu nisi dui. Suspendisse volutpat vulputate orci vel euismod. Cras id leo vel libero consectetur elementum id eu tortor. Vestibulum et quam vel magna ultricies pellentesque. In a dapibus sapien. Vivamus id nisi non nibh auctor ultrices. Aenean mollis lectus non erat imperdiet ac varius velit vulputate.

Morbi vel lectus ut orci venenatis porta a id dui. Proin libero lorem, laculis vel mollis vitae, vehicula at leo. Nam eros quam, ullamcorper ut porttitor eget, cursus ac dui. Vivamus placerat mi nec tortor consequat feugiat. In neque velit, eleifend vitae semper at, tempor nec urna. Quisque interdum nunc sit amet dolor vestibulum

lum a auctor nisi fermentum. Vivamus nisi turpis, bibendum elementum tincidunt a, convallis sit amet risus. Nulla facilisi.

Pellentesque habitant morbi tristique senectus et netus et malesuada fames ac turpis egestas. Aliquam tempor dapibus velit, ac dictum sem consectetur sit amet. Nam malesuada fermentum augue id mattis. Proin bibendum pharetra turpis at porta. Duis eleifend metus eu ipsum rhoncus lacinia. Donec laoreet mattis fermentum. Aliquam gravida consequat orci, quis tristique lectus bibendum ac. Quisque blandit nibh quis neque fermentum vel lacinia dui placerat. Donec porttitor facilisis tempor. Duis nec dui nibh, ac rutrum leo. In condimentum dui eget mauris congue scelerisque. Donec augue purus, aliquam ac ornare interdum, cursus in erat. Aliquam volutpat dapibus adipiscing. Ut sit amet purus magna, et dapibus nisi. Nulla dapibus lacinia commodo. Ut cursus, lectus et fermentum congue, lectus tellus pretium est, ac consequat turpis sem dictum libero.

[HOME](#)[ABOUT US](#)[CLIENTS](#)[SERVICES](#)[APPLY](#)[ARTICLES](#)[REFERENCES](#)[SCHEDULE ▾](#)[CONTACT US](#)

CJS GLOBAL

IS A BOUTIQUE
JANITORIAL
COMPANY WITH ITS ROOTS
FIRMLY PLANTED IN THE
HOSPITALITY
INDUSTRY.

BEING THE BRAINCHILD
OF A SUCCESSFUL
RESTAURANTEUR HIMSELF,
OUR VISION IS TO
PROVIDE EXCELLENCE
AT EVERY LEVEL OF OUR
BUSINESS RELATIONSHIPS
TO OUR CLIENTS,
VENDORS & STAFF.
THROUGH COMMITMENT,
DISCIPLINE & HARD WORK

CJS GLOBAL
STRIVES TO SURPASS
OUR COMPETITORS IN
QUALITY, INNOVATION &



Mimmos Italian

restaurant and bar

Chicken Carbonara

Ham, Peas, and Onions in a Vodka Cream Sauce

Lunch \$9.95



Catering

Pizza Parties
Buy 5 Large Pizzas and the 6th one is FREE!
Special Pricing on large pizza orders!

Side Dishes (Per Person)	
Meatballs	\$3.50
Sweet Italian Sausage	\$3.95
Pasta with Tomato Sauce	\$3.50
Wings	\$3.95

Menu

Pizza By The Slice	
Thin Slice	\$2.25
Sicilian Slice (Thick)	\$2.50
Additional Toppings	\$.75
Pizza Pies Personal Pizza 9" (4 Slices)	\$7.50
Medium Pizza 12" (6 Slices)	\$9.95
Large Pizza 16" (8 Slices)	\$13.95
Sicilian Pizza 14" (12 Slices)	\$5.50
Additional Toppings (Extra Cheese additional charge of \$.75)	
Personal Pizza	\$1.25 Per Topping
Medium Pizza	\$1.50 Per Topping
Large Pizza	\$1.75 Per Topping

Contact

954-586-5001

Fax: 954-586-5003

info@amimmositalian.com

Owner

Timeless Design for Exceptional Homes

[HOME](#) [ABOUT](#) [PORTFOLIO](#) [SERVICES](#) [CONTACT](#)



OUR PHILOSOPHY

For over 20 years MSI has been designing unique and beautiful, one of a kind interiors for a discerning clientele.

Let us bring our wealth of design expertise and experience to your project.

More text goes here. More text goes here. More text goes here. More text goes here. More text goes here. More text goes here. More text goes here. More text goes here. More text goes here.

More text goes here. More text goes here. More text goes here. More text goes here. More text goes here. More text goes here. More text goes here. More text goes here. More text goes here. More text goes here. More text goes here. More text goes here. More text goes here. More text goes here. More text goes here.

More text goes here. More text goes here. More text goes here. More text goes here. More text goes here. More text goes here. More text goes here. More text goes here. More text goes here. More text goes here. More text goes here. More text goes here. More text goes here. More text goes here. More text goes here.

1954 First Street #107
Highland Park, IL 60035
(847) 432-4528

Designed by Coast to Coast Publishing
Copyright 2011 © Maribeth Sullivan Interiors
All Rights Reserved

INVITATION DESIGNS

by Jessica Howard



50th
Anniversary
CELEBRATION

YOU AND A GUEST ARE INVITED
TO TRAVEL BACK IN TIME WITH US
AS WE CELEBRATE OUR SUCCESS

JOIN US AT STACHE

For Hors d'oeuvres and Hand-crafted Cocktails

Located at: 109 SW 2nd Ave, Fort Lauderdale, FL 33301

09.29.18 | 7PM-10PM

Please RSVP to rsvp@pirtleconstruction.com
by September 14th

Additional information to follow upon receipt of your RSVP

**Join Us
IF YOU DARE**

FOR PIRTLE'S ANNUAL
**CHILI COOKOFF &
HALLOWEEN CONTEST**

WEDNESDAY | OCTOBER 31ST | 12PM - 1:30PM

BRING YOUR BEST BATCH OF CHILI, WEAR YOUR FAVORITE COSTUME AND DON'T FORGET TO DECORATE YOUR WORK AREA FOR A CHANCE TO WIN AN AWESOME PRIZE!



The tasting and judging will take place at the Davie Office in the Grand Conference Room at 12 noon.

Prizes for the Chili Cookoff will be awarded to the first THREE places.

Prizes for the Halloween Contest will be awarded to the Scariest, Funniest, Most Creative Costumes and Best Decorated Work Area.

Please keep your costume work appropriate.

Please contact Merrie (merrie@pirtleconstruction.com) if you plan to participate in the Chili Cookoff.

**YOU AND YOUR FAMILY ARE INVITED TO
PIRTLE CONSTRUCTION'S
SUPERHERO
PICNIC**

Saturday, March 18, 2017 / 12:00PM - 4:00PM

T.V. (Topekeegee Yugnee) Park
3300 N. Park Road, Hollywood, FL 33021 - 8th floor *12

Please RSVP to Kat by March 3rd

Indicate how many adults and children in your party and ages of children

**WEAR YOUR FAVORITE SUPERHERO SHIRT!
IT'S SURE TO BE A**

BLAST!

**'tis the season
TO ROCK
UGLY
SWEATERS**



PLEASE JOIN US IN CELEBRATION OF THE HOLIDAY SEASON
BY WEARING YOUR UGLY HOLIDAY SWEATER

ON FRIDAY, DECEMBER 21ST

THE PERSON WITH THE UGLIEST SWEATER WINS A PRIZE!



Together with their families

JESSICA SHANNAHAN
& CORY HOWARD

invite you to share in their wedding
celebration sunday september eighteenth,
two thousand eleven at five thirty o'clock

The Oaks Waterfront Inn
25876 Royal Oak Road
Royal Oak, MD 21662

RSVP on our website
www.jc-wedding.info



JESSICA & CORY
09.18.11



OCTOBER 14, 2012 FROM 10 AM - WHENEVER

You're Invited
to a champagne brunch

AT THE HOME OF JESSICA & CORY HOWARD



5079 Heatherhill Lane, Unit 1 • Boca Raton, FL 33486



We can't wait to see you there!



EAT *drink* **& GIVE THANKS**

Please join us for Feasting and Festivities at the home of

JESSICA & CORY HOWARD

5079 Heatherhill Lane, Unit 1 | Boca Raton, Florida 33486

Wine and appetizers will start at 1pm and dinner will be served around 4pm

Please RSVP by responding to this email by November 19th and please let us know what side dishes you plan to bring

it's a BOY

please join us for a baby shower honoring

JESSICA HOWARD

At the home of Jessica and Cory Howard
3368 SW 16th Street • Ft Lauderdale, FL 33312



19 SATURDAY
OCTOBER

2 o'clock in the afternoon

RSVP - Madeleine

954.648.0725 or
madeleine@elitecrewintl.com

Registered at Target and Babies R Us

COMPLETE WEDDING DESIGN

by Jessica Howard







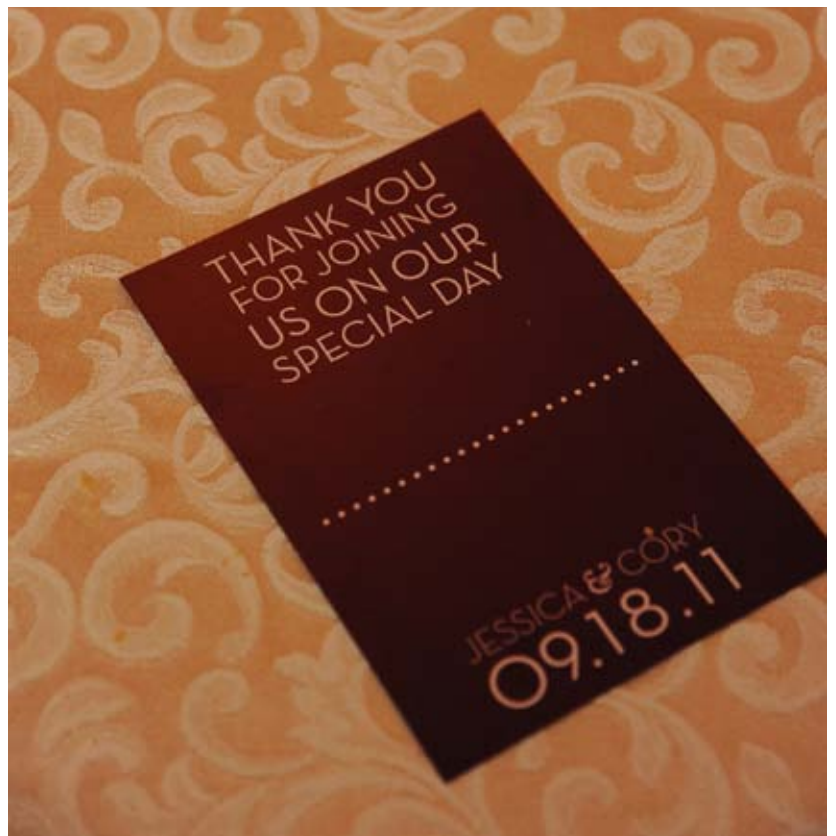

DIGITAL ILLUSTRATIONS / LOGO DESIGNS

by Jessica Howard

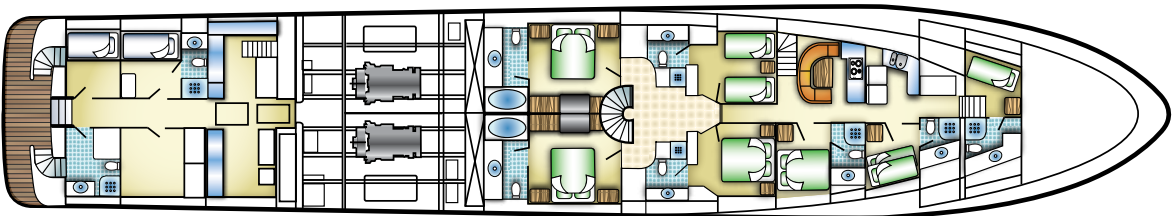
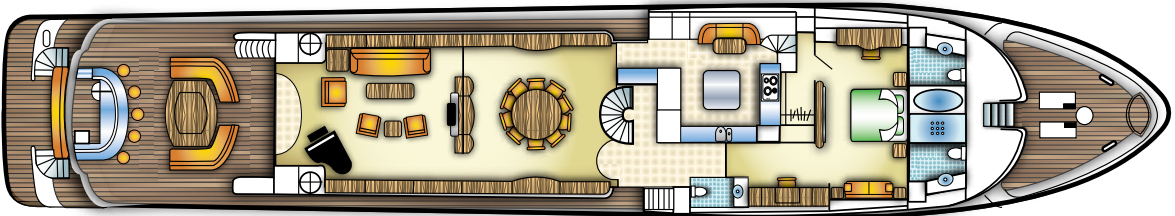
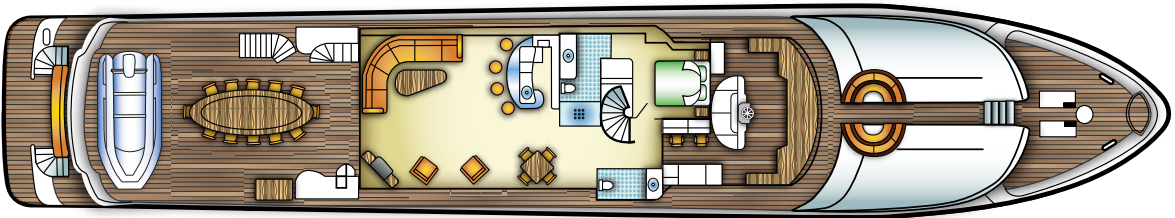
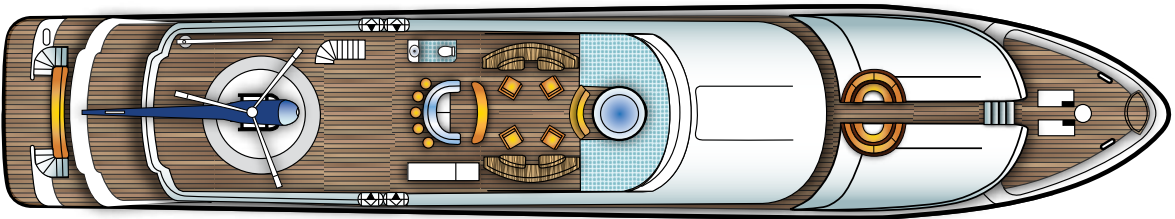

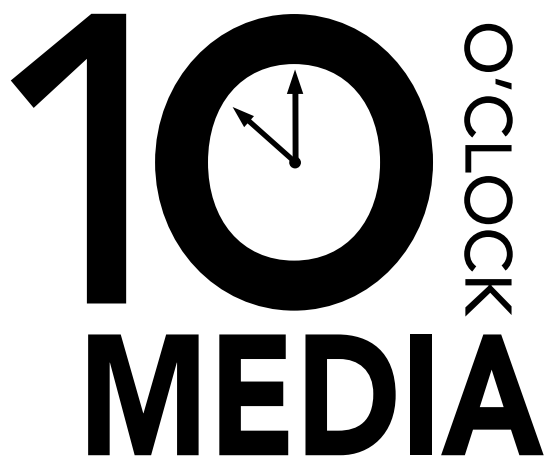

JANITORIAL PROPOSALS

by Jessica Howard

the Atlantic

HOTEL & SPA



JANITORIAL PROPOSAL





Rocco's Tacos

AND TEQUILA BAR



JANITORIAL PROPOSAL

PAINTINGS / SKETCHES

by Jessica Howard



